



urmet



OUTDOOR STATIONS

mikra

plus

EXTERNAL PANEL WITH
4 DIRECT CALL BUTTONS

REF. 1784/3

- > Presence detection to light on the display
- > 3,5" colour display
- > Wi-Fi direct built-in
- > 1784/3: 4 direct call buttons to 4 users and configuration by smartphone
- > 1784/4: address book up to 32 apartments and configuration by smartphone
- > IP65 and IK07
- > Wide angle camera (100°V - 113° H)
- > It's possible to have several of them on the installation (according to 2VOICE rules)

mikra

digital

EXTERNAL PUSH BUTTON
PANEL UP TO 32 USERS

REF. 1784/4



EXTERNAL PANEL WITH 4 DIRECT CALL BUTTONS

REF. 1784/3

EXTERNAL PUSH BUTTON PANEL UP TO 32 USERS

REF. 1784/4



2
voice

Main features

- > Two doors management (door and gate)
- > 2VOICE only
- > Open door detection
- > Input for local door open button
- > Up to 2 rows for each call name (i.e. double surname for the apartment)
- > Status indication by icons on the display
- > One screw only to mount it
- > 1784/3: 4 direct call buttons
- > 1784/4: up and down arrows keys, call key and delete key
- > Access to the programming by password on the front panel
- > Vocal feedback for the visitor actions
- > Accessories: ILA and MIFARE+ module 1784/45, keyboard for door open by code 1723/48

Components description

1. Speaker
2. Camera lighting LED
3. Camera
4. LCD display
5. Presence sensor
6. Calling buttons
7. Front closing screws
8. Microphone
9. Terminal boards
10. Programming button
11. Connector (J3) for connecting to ILA module
12. Speaker volume adjustment trimmer

FRONT VIEW

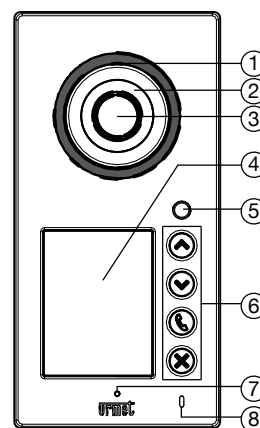
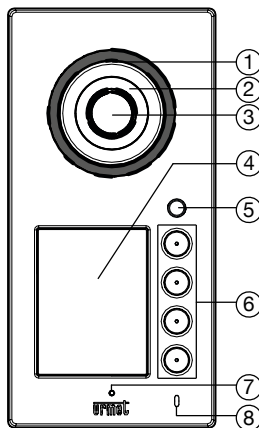

REAR VIEW

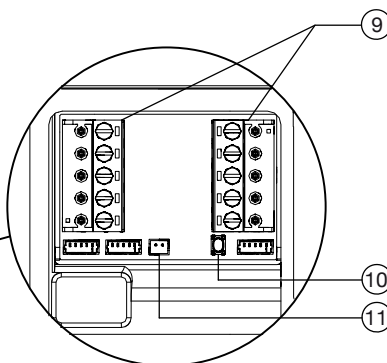
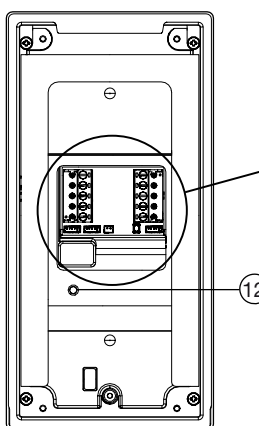



OUTDOOR STATIONS

**EXTERNAL PANEL WITH
4 DIRECT CALL BUTTONS**
REF. 1784/3

**EXTERNAL PUSH BUTTON
PANEL UP TO 32 USERS**
REF. 1784/4



2
voice

Technical specifications

Power voltage (LINE): 36 - 48 V

Stand-by consumption: max 50 mA

Max. consumption (video call in progress and name tags on): max 250 mA

Working temperature range: -5 °C ÷ + 45 °C

Degree of protection of casings: IP65

Degree of protection from mechanical shocks: IK07

Maximum potential free NO contact: max 200 mA @ 30 V

Dimensions (LxHxP): 99 x 200 x 26 mm - 3.89 x 7.87 x 1.02 in

Camera specifications

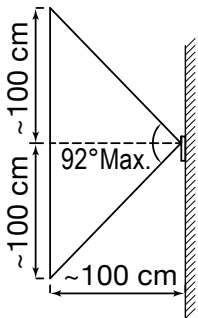

Vertical camera range

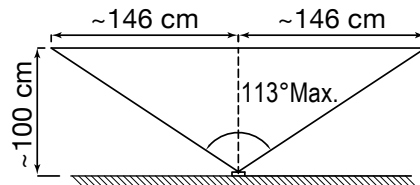

Horizontal camera range